

CONCRETE FINISHING RANGE

TIFON E-BATT

Battery-powered power trowels

The new range of ENAR TIFON E-BATT battery-powered trowels complements the existing TIFON range with two trowels of 600 and 900mm in diameter, fully battery-powered, being the most suitable option in terms of environmental impact and sustainability.

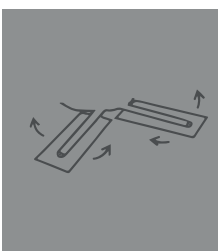

+ Adjustable blades

Designed to allow manual adjustment of the blade's inclination by the user.



+ Eco-Friendly

TIFON E-BATT has a much lower environmental impact thanks to its battery-powered electric motor.



+ Dead man's system

Two-way security system that disconnects the machine not only when user releases the handlebar but also when the trowel starts to turn uncontrollably

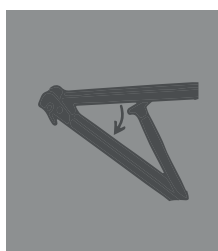

+ Foldable handle

Featured on models 600 and 900 for easy transportation.

- Thanks to their low noise level and their 100% emission-free battery operation, they are an excellent option for indoor work, enclosed environments, and works with restrictions
- Powerful Battery One BOB14 battery that offers up to 1h of continuous work on a single charge
- The TIFON E-BATT range is compatible with all accessories of the standard TIFON range: Disc and blades
- 140 minutes for a full charge, with the BOC13 charger (105 minutes for getting an 80% charge)



Technical Data

MODEL	Weight without battery (kg)	Working diameter (mm)	Max. speed (r.p.m.)	Power (kW)	Dimensions (mm)	Foldable handle	Autonomy (min)
TIFON 610	60	600	150	2.1	1470 x 710 x 1000	Yes	60*
TIFON 914	80	900	150	2.1	2550 x 950 x 1000	Yes	40*

*The data shown depends on the characteristics and slump of the concrete.

Battery BOB14

MODEL	Power (Wh)	Tension (V)	Weight (kg)
BOB14	1425	51	10